

Cleaning the coffee machine parts

Group head and portafilter:

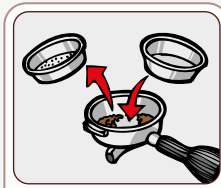

1. Replace the empty filter basket with the blind filter provided from the machine supplier.



2. Add the recommended amount of detergent (liquid or powder) into the group.

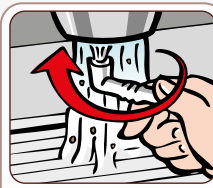

3. Clean the group gasket by flushing the machine & the silicon brush.



4. Snap the blind filter basket into your portafilter and start the machine's group 5 times 5 seconds. (start/stop intervals).

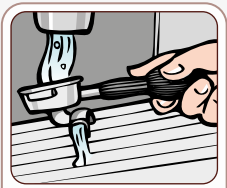

5. Remove the portafilter to rinse the group head - start the machine only using water. Repeat the back flushing process with clean water several times.

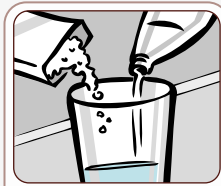

6. Fill a glass bowl or container with the recommended amount of water and detergent.



7. Put the portafilter separately from the filter basket into the washing-water for 5 minutes. Please note: only place the metal part of the portafilter in the cleaning water!



8. Wash the portafilter & filter basket with hot water and dry it with a fresh cloth.

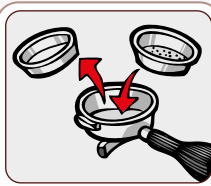

9. Put portafilter and filter basket back together.

Cleaning the steam wand:

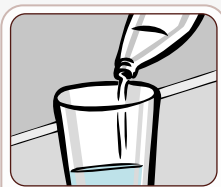

1. Put some cold water and a liquid detergent in a glass.

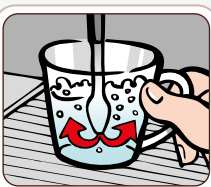

2. Dip the steam wand into the water and put the steam on, until the water is hot.

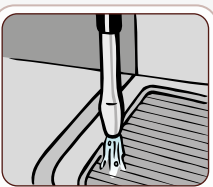

3. Take the steam wand out of the water and turn on the steam valve for 30 seconds.

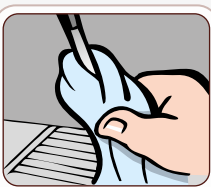

4. Clean the steam valve with a clean wet cloth.

Note:

The coffee machine has to be cleaned daily. Use only prescribed detergent (liquid or powder). Do not use detergent that can damage metal surfaces, rubber or plastic. Always rinse all parts very well with water after the cleaning.